

PERMIT
 CITY OF NAPOLEON, OHIO - BUILDING DEPARTMENT
 255 West Riverview Avenue, Napoleon, Ohio 43545 - (419) 592-4010

Permit No. 2568 Issued 2-28-92

Job Location 965 Chesterfield

Lot 26 Twin Oaks Subdivision

Issued by Brent N. Damman

Owner Bonnie Dunmire 599-9894

Address 907 Huddle Rd., Napoleon, OH

X Agent Four Seasons Homes 599-0836

Address 610 Cripple Creek Ct.,
Napoleon, Ohio 43545

Use Type - Residential xx

Other - Describe _____

No. Dwelling Units 1

New xx Replacement _____

Add'n. _____ Alter _____ Remodel _____

Mixed Occupancy _____

Change of Occupancy _____

Estimated Cost \$ 110,000.00

FEES	BASE	PLUS	TOTAL
<input checked="" type="checkbox"/> Building	\$ 9.00	\$ 284.00	\$ 293.00
<input checked="" type="checkbox"/> Electrical	\$ 15.00	\$ 75.00	\$ 90.00
<input checked="" type="checkbox"/> Plumbing	\$ 9.00	\$ 30.00	\$ 39.00
<input checked="" type="checkbox"/> Mechanical	\$ 18.00	\$ 22.00	\$ 40.00
<input type="checkbox"/> Demolition	\$ _____	\$ _____	\$ _____
<input type="checkbox"/> Zoning	\$ _____	\$ _____	\$ _____
<input type="checkbox"/> Sign	\$ _____	\$ _____	\$ _____
<input checked="" type="checkbox"/> Water Tap	\$ 375.00	\$ _____	\$ 375.00
<input type="checkbox"/> Sew. Insp.	\$ _____	\$ _____	\$ _____
<input checked="" type="checkbox"/> Sewer Tap	\$ 250.58	\$ _____	\$ 250.58
<input checked="" type="checkbox"/> Temp. Water	\$ 5.00	\$ _____	\$ 5.00
<input checked="" type="checkbox"/> Temp. Elec.	\$ 10.00	\$ _____	\$ 10.00
TOTAL FEES.....			\$ 1102.58
LESS FEES PAID.....			\$ _____
BALANCE DUE.....			\$ 1102.58

ZONING INFORMATION

district	lot dimensions		area	front yd	side yd	rear yd
max hgt	no pkg spaces	no ldg spaces	max cover	petition or appeal req'd	date appr	

WORK INFORMATION

Size: Length 48' Width 31' Stories 2 Ground Floor Area 1222

Height 22' Building Volume (for Demo. Permit) _____

Electrical: New Home

Plumbing: New Home

Mechanical: New Home

Additional Information: _____

Date 2-28-92 Applicant Signature Daniel Brubaker

CITY OF NAPOLEON
 APR 27 1992
 PAID

INSPECTION RECORD

	UNDERGROUND			ROUGH-IN						FINAL		
	Type	Date	By	Type	Date	By	Type	Date	By	Type	Date	By
PLUMBING	Building Drains			Drainage, Waste & Vent Piping	6/1	BD	Indirect Waste	9/18	BD	Drainage, Waste & Vent Piping	9/18	BD
	Water Piping									Backflow Prevention	9/18	BD
	Building Sewer	6/16	BD	Water Piping	6/1	BD	Condensate Lines	9/18	BD	Water Heater	9/18	BD
	Storm	6/16	BD									
	Sewer Connection	6/16	BD							FINAL APPROVAL		
MECHANICAL	Refrigerant Piping			Refrigerant Piping			Chimney(s)			Grease Exhaust System		
				Duct Furnace(s)			Fire Dampers			Air Cond. Unit(s)	9/18	BD
	Ducts/Plenums			Ducts/Plenums	6/1	BD	<input type="checkbox"/> Radiant Htr(s) <input type="checkbox"/> Unit Htr(s)			Refrigeration Equipment		
				Duct Insulation	6/1	BD	Pool Heater			Furnace(s)	9/18	BD
			Combustion Products Vents	9/18	BD	Ventilation <input type="checkbox"/> Supply <input checked="" type="checkbox"/> Exhst.	9/18	BD	FINAL APPROVAL			
ELECTRICAL	Conduits & or Cable			Conduits/Cable	5/22	BD	<input type="checkbox"/> Range <input type="checkbox"/> Dryer			Temp Service Temp Lighting		
	Grounding & or Bonding	5/22	BD	Rough Wiring	6/1	BD	<input type="checkbox"/> Generator(s) <input type="checkbox"/> Motors			Fixtures Lampholders	9/18	BD
	Floor Ducts Raceways			Service Panel Switchboard	6/1	BD	<input type="checkbox"/> Water Htr <input type="checkbox"/> Welder			Signs		
	Service Conduit	5/22	BD	Busways Ducts			<input type="checkbox"/> Heaters <input type="checkbox"/> Heat Cable			Electric Mtr. Clearance	9/18	BD
	Temporary Power Pole			Subpanels			<input type="checkbox"/> Duct Htr(s) <input type="checkbox"/> Furnace(s)			FINAL APPROVAL	9/18	BD
BUILDING	Location, Set-backs, Esmt(s)			Exterior Wall Construction	6/1	BD	Roof Covering Roof Drainage	6/1	BD	Smoke Detector	9/18	BD
	Excavation	7/16	BD				Exterior Lath	6/1	BD	Demolition (sewer cap)		
	Footings & Reinforcing	5/16	BD				<input checked="" type="checkbox"/> Interior Lath <input checked="" type="checkbox"/> Wallboard	9/18	BD			
	Floor Slab	5/22	BD	Interior Wall Construction	6/1	BD	Fire Wall(s)			Building or Structure	9/18	BD
	Foundation Walls	5/22	BD	Columns & Supports			Fireplace Chimney					
	Sub-soil Drain			Crawl Space <input type="checkbox"/> Vent <input type="checkbox"/> Access	6/1	BD	Attic <input checked="" type="checkbox"/> Vent <input checked="" type="checkbox"/> Access	9/18	BD			
	Piles			Floor System(s)	6/1	BD				FINAL APPROVAL BLDG. DEPT.	9/18	BD
			Roof System	6/1	BD	Special Insp Reports Rec'd			Certificate of Occupancy Issued			
ADDITIONAL	INSPECTIONS, CORRECTIONS, ETC.						INSPECTIONS, CORRECTIONS, ETC.					
	Need to paint attic door with fire rated paint.											
	Need to provide combustion air for furnace.											

APPLICATION
for
RESIDENTIAL, BUILDING, ELECTRICAL, PLUMBING, MECHANICAL, PERMITS AND DEMOLITION
from the
CITY OF NAPOLEON - BUILDING DEPARTMENT
255 West Riverview Avenue, Napoleon, Ohio 43545 - Phone 419-592-4010

Entry No. _____		<u>BASE</u>	<u>PLUS</u>	<u>TOTAL</u>
Permit No. <u>2568</u> Issued <u>2-28-92</u>	:	<input checked="" type="checkbox"/> Building \$ <u>9.00</u>	\$ <u>284.00</u>	\$ <u>293.00</u>
Job Location <u>965 Chesterfield</u>	:	<input checked="" type="checkbox"/> Electrical \$ <u>15.00</u>	\$ <u>75.00</u>	\$ <u>90.00</u>
Lot <u>26</u> <u>TWIN OAKS Subdivision</u> sub-div or legal description	:	<input checked="" type="checkbox"/> Plumbing \$ <u>9.00</u>	\$ <u>30.00</u>	\$ <u>39.00</u>
Issued by <u>BND</u> Building Official	:	<input checked="" type="checkbox"/> Mechanical \$ <u>18.00</u>	\$ <u>22.00</u>	\$ <u>40.00</u>
Owner <u>BONNIE DUNMIRE</u> Phone <u>599-9894</u>	:	Demolition \$ _____	\$ _____	\$ _____
<input checked="" type="checkbox"/> Address <u>907 Huddle Rd.</u>	:	Zoning \$ _____	\$ _____	\$ _____
Agent <u>Four Seasons Homes</u> Phone <u>599-0836</u>	:	Sign \$ _____	\$ _____	\$ _____
Address <u>610 Cripple Creek Ct.</u>	:	<input checked="" type="checkbox"/> Water Tap \$ <u>375.00</u>	\$ _____	\$ <u>375.00</u>
Description of Use <u>NEW HOME</u>	:	<input checked="" type="checkbox"/> Sewer Tap \$ <u>250.58</u>	\$ _____	\$ <u>250.58</u>
Residential <u>1</u> (number dwelling units)	:	<input checked="" type="checkbox"/> Temp Water \$ <u>5.00</u>	\$ _____	\$ <u>5.00</u>
Commercial _____ Industrial _____ New _____	:	<input checked="" type="checkbox"/> Temp Elec. \$ <u>10.00</u>	\$ _____	\$ <u>10.00</u>
New <input checked="" type="checkbox"/> Addition _____ Replacement _____ Remodel _____	:	Additional Structure _____	Hours _____	
Mixed Occupancy _____ Change of Occupancy _____	:	Plan _____		
	:	Review Electric _____	Hours _____	
<input checked="" type="checkbox"/> Estimated Cost: \$ <u>110,000.00</u>	:	TOTAL FEES -----		\$ <u>1102.58</u>
	:	Less Fees Paid (date) _____	\$ _____	
	:	BALANCE DUE -----		\$ <u>1102.58</u>

ZONING INFORMATION:

District	Lot Dimensions	Area	Front Yard	Side Yard	Rear Yard

Max. Hgt.	No. Pkg. Spaces	No. Ldg. Spaces	Max Cover	Petition or Appeal Required/Date

WORK INFORMATION:

Building - Garage Floor Area 550 Basement Floor Area _____ 2nd Floor Area 675

Size - Length 48' Width 31' Stories 2 Ground Floor Area 1222

Height 22' Building Volume (For Demolition Permit) _____ cubic feet

Description of Work: New Home

ELECTRICAL: Electrical Contractor FOUR SEASONS HOMES Phone 599-0836
Address 610 CRIPPLE CREEK Ct. NAPOLEON Estimated Cost: \$ 4000.00
Type of Work: New Service Change _____ Rewiring _____ Add'l. Wiring _____ Temp. Electric Required: Yes _____ No _____
Size of Service 200 Underground Overhead _____ Number of New Circuits 25
Description of Work: _____

PLUMBING: Plumbing Contractor FOUR SEASONS HOMES Phone 599-0836
Address 610 CRIPPLE CREEK Ct. NAPOLEON Estimated Cost: \$ 4000.00
Water Tap Required: Yes No _____ Size _____ Type of Pipe _____ Water Dist. Pipe _____
Sanitary Sewer Tap Required: Yes No _____ Size _____ Type of Pipe _____ Dr. Waste Vt. Pipe _____
St. Sewer Tap Req.: Yes No _____ Size _____ Type of Pipe _____ Street to be Opened: Yes _____ No _____
Main Building Drain Size: 3" Main Vent Pipe Size: 3"

List Number of PLUMBING Fixtures below:

Water Closets 2 Bathtubs 2 Showers _____ Lavatories 2 Kitchen Sinks 1 Disposal _____ Dishwasher 1
Clothes Washer 1 Floor Drains 1 Other (Fixtures/Type): Total -

Description of Work: _____

MECHANICAL: Mechanical Contractor _____ Phone _____
Address _____ Estimated Cost: \$ 4000.00

Heating System: Forced Air _____ Gravity _____ Hot Water _____ Steam _____ Unit Heaters _____ Radiant _____ Baseboard _____

Type of Fuel: Electric _____ Natural Gas _____ Propane _____ Wood _____ Coal _____ Solar _____ Geothermal _____ Other _____

Number of Heat Zones: _____ Hot Water: (One Pipe _____ Two Pipe _____ Series Loop _____)

Electric Heat: (No. of Circuits _____) No. of Furnaces No. of Hot Air Runs 20

No. of Hot Water Radiators _____ Total Heat Loss _____ Rated Capacity of Furnace/Boiler _____

Location of Heating Units: Crawl Space _____ Floor Level _____ Attic _____ Suspended _____ Roof _____ Outside _____

Description of Work: _____

DRAWINGS REQUIRED: All Applications must be accompanied by two (2) complete set of Drawings including Site Plans, Foundation Plans, Floor Plans, Structural Framing Plans, Exterior Elevations, Section and Details, Stair Details, Electrical Layout, Plumbing Isometric, Heating Layout, etc. All Plans shall be DRAWN TO SCALE, show all existing structure on the Site Plans also, show Electric Panel and Furnace Locations.

READ AND SIGN BELOW: The undersigned hereby makes application for a Permit for all work described herein, and agrees to complete the work in strict accordance with all applicable provisions of the current edition of the C.A.B.O. Building Code, the Napoleon Building and Zoning Codes, the Napoleon Engineering Department Rules and Regulations, Standard Specifications and other Pertinent Sections of the Napoleon Code of Ordinances.

Dated: _____ Signature of Applicant _____

WATER TAPPING PERMIT

issued by

The Napoleon Water Distribution Department
255 West Riverview Ave. Napoleon, Ohio 43545 Ph. 592-4010

Permit No. W- 0526 Issued 5-14-92 Received of Four Seasons Homes (\$ 375).00

(Charge for tapping permit to supply water service to) Lot No. 26 Sub Div. Linn Oaks 1st.

Street No. 965 Chesterfield Tap Size 1 " Cost \$ 375 .00 Plumber Danman P4H

Date completed _____ Approved by _____
water distribution dept. finance director

Name Four Seasons Homes Size of tap 1" Date 6-17-92 Street and No. 965 Chesterfield

Old Tap No. _____ New Tap No. 9235 Size and Kind of Main 8" C-900

Location of Main 5' north of north curb Depth of Main 5'

Distance from Hydrant/Valve 256' east of Hyd # 403 Distance to Curb Stop from Corp. 12'

COMPLETED

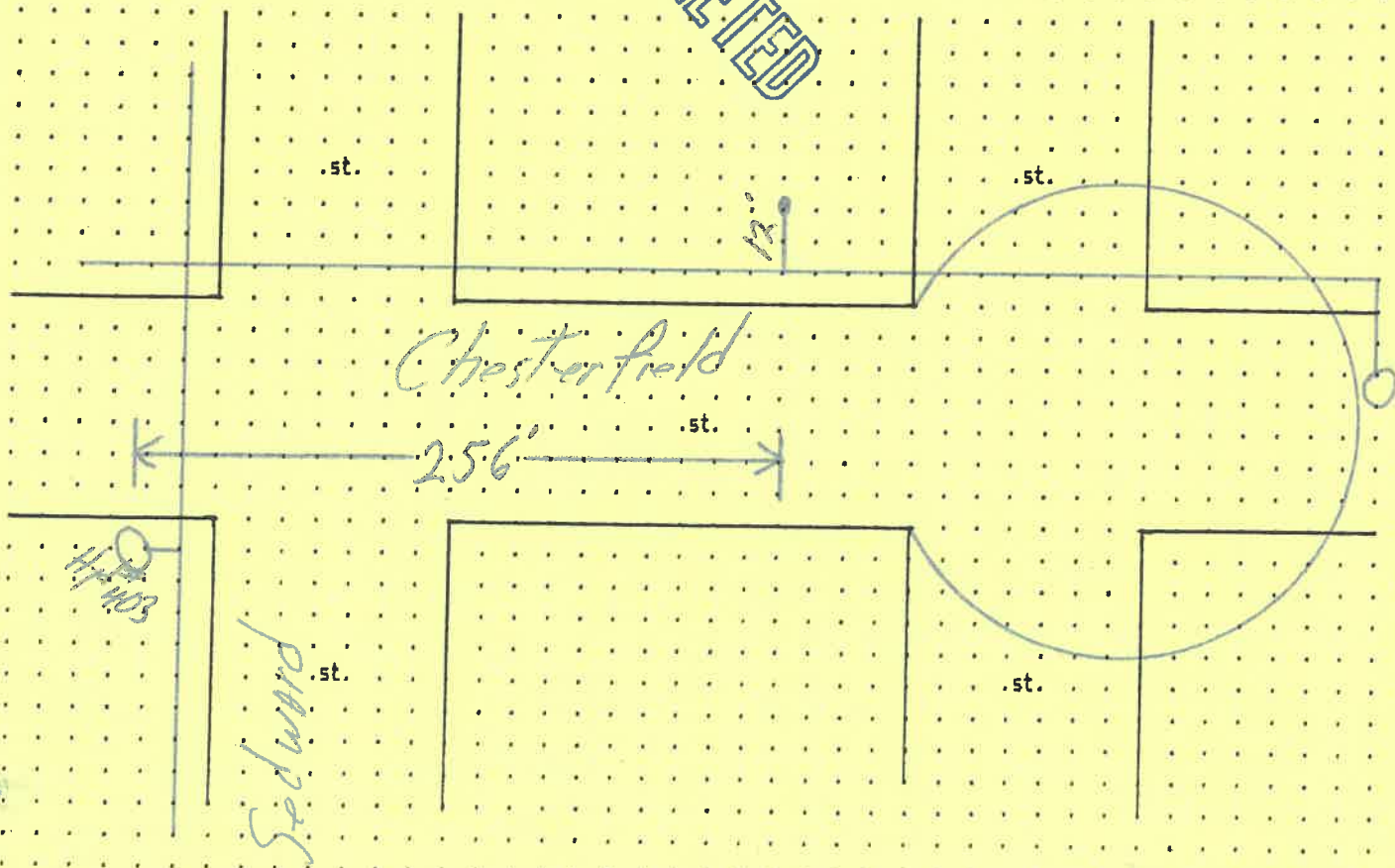

WATER TAPPING PERMIT

issued by

The Napoleon Water Distribution Department

255 West Riverview Ave. Napoleon, Ohio 43545 Pn. 592-4010

Permit No. W- 0026 Issued 5-14-92 Received of Flow Season Homes (\$ 375) .00

(Charge for tapping permit to supply water service to) Lot No. 26 Sub Div. Twin Oaks 1st.

Street No. 965 Chesterfield Tap Size 1 Cost \$ 375 .00 Plumber Danman P+H

Date completed _____ Approved by _____
water distribution dept. finance director

Name _____ Size of tap _____ Date _____ Street and No. _____

Old Tap No. _____ New Tap No. _____ Size and Kind of Main _____

Location of Main _____ Depth of Main _____

Distance from Hydrant/Valve _____ Distance to Curb Stop from Corp. _____

COMPLETED

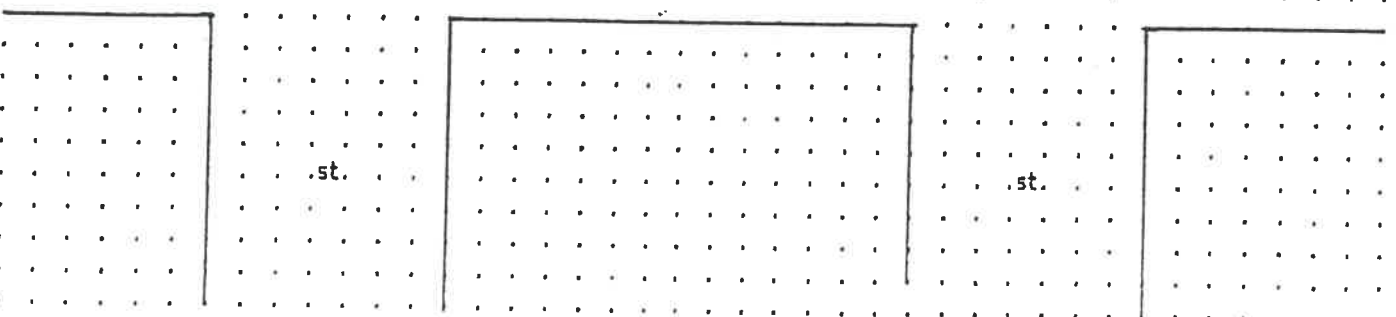
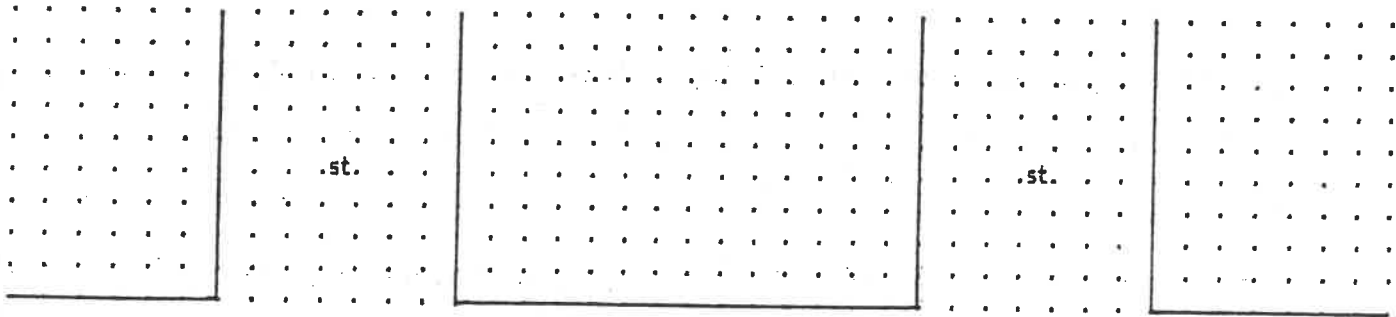

METER SOCKET RELEASE

issued by

The Napoleon Electric Distribution Department

639 Industrial Drive Napoleon, Ohio 43545 Pn. 592-9116 or 592-4010

Permit No. E-0064 Issued 5-6-92 Building permit No. 2568 Job Address 965 Chester field

Lot Number 26 Sub Division Twin Oaks 1st add

Owner Bonnie Duamire Owners Address 907 Huddle Rd Napoleon Pn. No. 599-9894

Contractor Four Seasons Homes Contractors Address 610 Cuyahoga Creek Napoleon Pn. No. 599-0836

Size of Service 200 Overhead Underground X Issued By Duane M. Damman

Date completed Approved by

Size of Service Overhead Underground Street and No. electric distribution dept.

Old Meter No. New Meter No. Remarks

COMPLETED

Sketch of Service

Grid area for sketch of service

501087

done 5-27-92

S.B. GK. C.M.

CHESTERFIELD

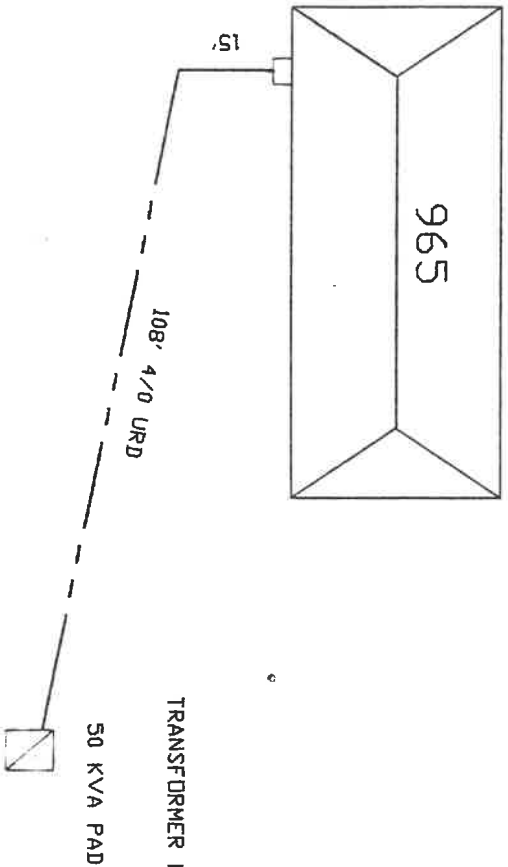

Napoleon Power & Light

1775 Industrial Drive
Napoleon, Ohio

ITEM 965 CHESTERFIELD

DATE	WO#	JO#	ISSUED BY
5/21/92	24564	071097	WTH



City of NAPOLEON, OHIO

255 RIVERVIEW AVENUE - (419) 592-4010
NAPOLEON, OHIO 43545-0151

Mayor
Steven Lankenau

April 22, 1992

Members of Council
Terri A. Williams, President
John E. Church
Michael J. DeWit
Dennis L. Filgor
Robert G. Heft
James Hershberger

Mr. Daniel Brubaker
Four Seasons Homes
610 Cripple Creek Ct.
Napoleon, Ohio 43545

Re: New Home At
965 Chesterfield

Dear Dan:

The Building Permit for the above referenced job has been completed and the balance due is \$1,102.58. You may stop in at the City Building Utilities Department to pay for this permit any time.

Sincerely,

City Manager
Terry Dunn

Finance Director
Rupert W. Schweinhagen

Law Director
Michael J. Wesche

Prosecuting Attorney
Thomas L. Bischoff

Brent N. Damman
Building/Zoning
Inspector

BND:rw

